

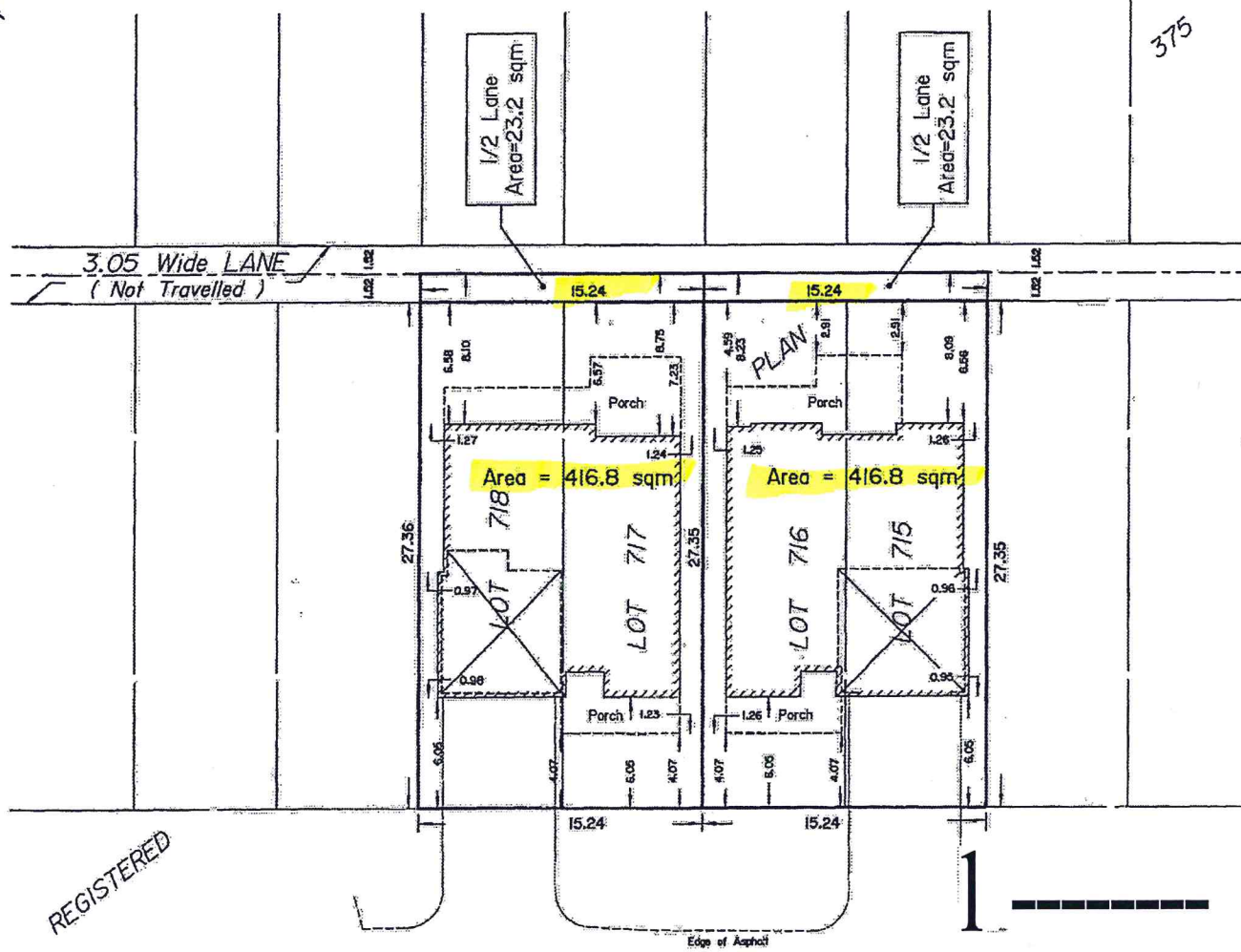

SITE PLAN OF
LOTS 715, 716, 117 and 116
REGISTERED PLAN 375
CITY OF OTTAWA
 Prepared by Annis, O'Sullivan, Vollebek Ltd.
 November 13, 201

Scale 1: 250

Metric
 DISTANCES SHOWN ON THIS PLAN ARE IN METRES AND
 CAN BE CONVERTED TO FEET BY DIVIDING BY 0.3048



Notes & Legend

Half lane permitted for use per zoning By-Law R1FF
 exception:632.

Committee of Adjustment
 JAN 08 2020
 City of Ottawa

REGISTERED

RITA AVENUE

© Annis, O'Sullivan, Vollebek Ltd, 2019. THIS PLAN IS PROTECTED BY COPYRIGHT
ANNIS, O'SULLIVAN, VOLLEBEKK LTD.
 14 Concourse Gate, Suite 500
 Nepean, Ont. K2E 7S8
 Phone: (613) 727-0950 / Fax: (613) 727-1079
 Email: Nepean@ovltd.com
 Ontario Land Surveyors Job No. 20342-19 Bergron Lts 715-716 RP 375 SP DJ

C:\3019\10113-19\Drawings\20312-10 Bergron Lts 715-716 RP 375 SP DJ.dwg

