

BY-LAW NO. 2019 – _____

A by-law of the City of Ottawa for the making of an application for approval to expropriate a property interest in the City of Ottawa for the purposes of the Stage 2 Ottawa Light Rail Transit System project, as more particularly described in Schedules “A” and “B” to this by-law.

WHEREAS the City of Ottawa requires property interests described in Schedule “A” and in Schedule “B” attached hereto for the Stage 2 Ottawa Light Rail Transit System project (the “Stage 2 LRT”) and for municipal utilities including, but not limited to, for the purposes of facilitating the construction, installation, assembly, operation, use, maintenance, repair, renewal, replacement and removal of light rail and bus transit infrastructure, guideway corridors, guideways, roads, vehicle access, transit stations and entrances, platforms, multi-use pathways, pedestrian walkways, bridges and bridge approaches and all other improvements and works ancillary to Stage 2 LRT and municipal utilities including sanitary and stormwater sewers and all works, systems, conduits, ducts, manholes and apparatus appurtenant thereto together with temporary easements in support of the foregoing, for durations of fifty five (55), seventeen (17), or twelve (12) months as described in Schedule “A” hereto, for purposes including, but not limited to, storage of excavated materials, construction materials and equipment, temporary support of excavation, temporary power supply, parking, vehicular and pedestrian access and egress, traffic management and detouring, and to enter and remain on the lands with all vehicles, machinery, workmen and material for construction, renewal, relocation installation and assembly of light rail and bus transit infrastructure, private and municipal utilities, grading, fences, retaining walls and landscaping features and all works ancillary to Stage 2 LRT;

AND WHEREAS pursuant to Section 6(1) of the *Municipal Act, 2001, S.O. 2001, c. 25*, as amended, the power of a municipality to acquire land under this or any other Act includes the power to expropriate land in accordance with the *Expropriations Act*, R.S.O. 1990, c.E.26, as amended (hereinafter referred to as the “*Expropriations Act*”);

AND WHEREAS pursuant to Section 4 of the *Expropriations Act*, an expropriating authority, in this case, the City of Ottawa, shall not expropriate land without the approval of the approving authority, in this case, the Council of the City of Ottawa;

AND WHEREAS the City of Ottawa shall conduct the expropriation in accordance with the *Expropriations Act*.

THEREFORE the Council of the City of Ottawa hereby enacts as follows:

1. THAT the Council of the City of Ottawa hereby approves the making of an application for approval to expropriate land by the City of Ottawa, in respect of the property described in Schedule “A” and Schedule “B”, appended hereto.

2. THAT the Mayor, the City Clerk, and the Director of Corporate Real Estate Office, or any one of them are hereby authorized to execute, on behalf of the City of

Ottawa, an Application for Approval to Expropriate the property described in Schedule "A" and Schedule "B" appended hereto.

3. THAT the Mayor, the City Clerk, and the Director of Corporate Real Estate Office, or any one of them are hereby authorized to execute, on behalf of the City of Ottawa, Notices of Application for Approval to Expropriate Land for the property described in Schedule "A" and Schedule "B" appended hereto and that such Notices be served and published, as required by the *Expropriations Act*.

4. THAT, in the event an owner or registered owner requests a hearing of necessity, and a report of the inquiry officer is issued, the report of the inquiry officer shall come before Council of the City of Ottawa for consideration.

5. THAT the officers and authorized agents of the City of Ottawa be and they are hereby otherwise authorized and directed to do all things required arising from the authorizations provided for by this by-law.

6. THAT this by-law comes into force on the day it is passed.

ENACTED and PASSED this 27th day of March, 2019.

CITY CLERK

MAYOR

SCHEDULE "A"

Confederation Line – West

All right, title and interest in the following lands:

1. Part of PIN 04701-0103 (LT) being PART OF BLOCK I PLAN 465465, PARTS 7 TO 14, AND 20, ON 4R14855, NEPEAN designated as Parcel 2 on drawing 18689-PRP_064d.dgn

An estate, right or interest, in the nature of a permanent easement in the following lands:

2. Part of PIN 04701-0101 (LT) being PART OF BLOCK A PLAN 465465, PARTS 1 AND 2 PLAN 4R14855, NEPEAN designated as Parcel 1 on drawing 18689-PRP_064d.dgn
3. Part of PIN 04701-0103 (LT) being PART OF BLOCK I PLAN 465465, PARTS 7 TO 14, AND 20, ON 4R14855, NEPEAN designated as Parcel 10 on drawing 18689-PRP_064d.dgn
4. Part of PIN 04701-0118 (LT) being PART OF BLOCKS I, J, L AND THE 1' FOOT RESERVE, BLOCK K ON PLAN 465465 AND PART OF LOT 17, CONCESSION 2 (NEPEAN) BEING PART 1 ON PLAN 4R-542 SAVE AND EXCEPT PARTS 4 TO 9 ON PLAN 4R-14928, OTTAWA. TOGETHER WITH AN EASEMENT OVER PARTS 5, 7 AND 8 ON PLAN 4R-14928 AS IN LT1327791. TOGETHER WITH AN EASEMENT OVER PARTS 16, 17 AND 19 ON PLAN 4R-14855 AS IN LT1327796. TOGETHER WITH A RIGHT OF WAY OVER PARTS 4 TO 9 ON PLAN 4R-14928 AS IN LT1327791 designated as Parcels 3 and 4 on drawing 18689-PRP_064d.dgn

An estate, right or interest, for a limited time in the nature of a temporary easement for a period of fifty-five (55) months in the following lands:

5. Part of PIN 04701-0101 (LT) being PART OF BLOCK A PLAN 465465, PARTS 1 AND 2 PLAN 4R14855, NEPEAN designated as Parcels 1 and 5 on drawing 18689-PRP_064d.dgn
6. Part of PIN 04701-0103 (LT) being PART OF BLOCK I PLAN 465465, PARTS 7 TO 14, AND 20, ON 4R14855, NEPEAN designated as Parcels 6, 7 and 10 on drawing 18689-PRP_064d.dgn

An estate, right or interest, for a limited time in the nature of a temporary easement for a period of twelve (12) months in the following lands:

7. Part of PIN 04701-0118 (LT) being PART OF BLOCKS I, J, L AND THE 1' FOOT RESERVE, BLOCK K ON PLAN 465465 AND PART OF LOT 17, CONCESSION 2 (NEPEAN) BEING PART 1 ON PLAN 4R-542 SAVE AND EXCEPT PARTS 4 TO 9 ON PLAN 4R-14928, OTTAWA. TOGETHER WITH AN EASEMENT OVER PARTS 5, 7 AND 8 ON PLAN 4R-14928 AS IN LT1327791. TOGETHER WITH AN EASEMENT

OVER PARTS 16, 17 AND 19 ON PLAN 4R-14855 AS IN LT1327796. TOGETHER WITH A RIGHT OF WAY OVER PARTS 4 TO 9 ON PLAN 4R-14928 AS IN LT1327791 designated as Parcels 8 and 9 on drawing 18689-PRP_064d.dgn

Trillium Line

An estate, right or interest, for a limited time in the nature of a temporary easement for a period of seventeen (17) months in the following lands:

8. Part of PIN 04102-0135(LT) being PT LT 1, BLK G, PL 146 , PT LT 3, BLK G, PL 146 , LT 4, BLK G, PL 146 , S/S HICKORY ST, E OF CHAMPAGNE AV ; PT LT 10, BLK G, PL 146 , LT 11, BLK G, PL 146 , LT 12, BLK G, PL 146 , LT 13, BLK G, PL 146 , LT 14, BLK G, PL 146 , E/S CHAMPAGNE AV ; PT LT 5, BLK G, PL 146 , LT 6, BLK G, PL 146 , LT 7, BLK G, PL 146 , LT 8, BLK G, PL 146 , LT 9, BLK G, PL 146 , W/S RAILWAY ST, E OF CHAMPAGNE AV ; LT 15, BLK G, PL 146 , LT 16, BLK G, PL 146 , LT 17, BLK G, PL 146 , LT 18, BLK G, PL 146 , N/S CARLING AV, E OF CHAMPAGNE AV, EXCEPT PT EXPROPRIATED FOR CARLING AV IN CR342213; ALL AS IN CR112644 ; PT RAILWAY ST, PL 73 , AS CLOSED BY ORDER CR564781, AS IN CR616246 ; OTTAWA/NEPEAN designated as Parcel 1 on drawing 18692-PRP_43.dgn

SCHEDULE "B" – PROPERTY SKETCHES

Confederation Line – West

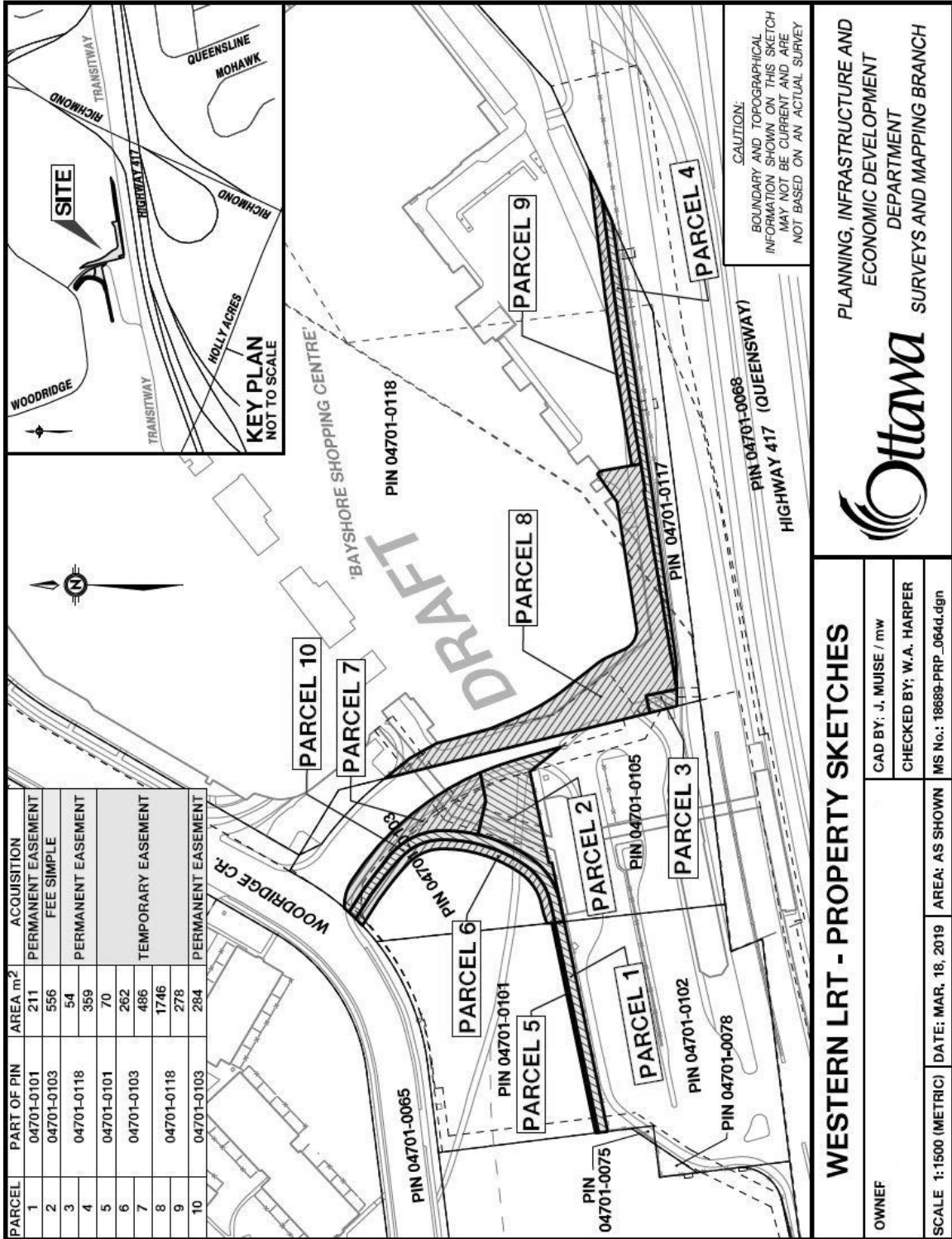

PARCEL	PART OF PIN	AREA m ²	ACQUISITION
1	04701-0101	211	PERMANENT EASEMENT
2	04701-0103	556	FEE SIMPLE
3	04701-0118	54	PERMANENT EASEMENT
4	04701-0101	359	PERMANENT EASEMENT
5	04701-0101	70	TEMPORARY EASEMENT
6	04701-0103	262	TEMPORARY EASEMENT
7	04701-0118	486	TEMPORARY EASEMENT
8	04701-0118	1746	TEMPORARY EASEMENT
9	04701-0103	278	PERMANENT EASEMENT
10	04701-0103	284	PERMANENT EASEMENT

WESTERN LRT - PROPERTY SKETCHES

OWNEF	
CAD BY: J. MUJISE / mw	
CHECKED BY: W.A. HARPER	
MS No.: 18689-PRP_064d.dgn	
SCALE 1:1500 (METRIC)	DATE: MAR. 18, 2019
AREA: AS SHOWN	

PLANNING, INFRASTRUCTURE AND ECONOMIC DEVELOPMENT DEPARTMENT
Ottawa
 SURVEYS AND MAPPING BRANCH

Trillium Line

