

PLAN 4R--
RECEIVED AND DEPOSITED

DATE _____

REPRESENTATIVE FOR
LAND TITLES DIVISION OF
OTTAWA - CARLETON (N. 4)

DATE _____

JOHN H. GUTRI, O.L.S.

FAIRHALL, MOFFATT & WOODLAND LIMITED
ONTARIO LAND SURVEYORS

SCALE 1 : 250
0 5 10 20 25 metres

COORDINATES WERE DERIVED FROM REAL TIME NETWORK
OBSERVATIONS (SMARTNET) WITH ZONE 9, MADDS ORIGINAL.
COORDINATES HAVE BEEN DETERMINED TO AN URBAN ACCURACY
IN ACCORDANCE WITH SECTION 14(2) OF OREG. 216/10.

POINT ID	NORTHING	EASTING
1	*	*
2	*	*
3	*	*
4	*	*
5	*	*
6	*	*
7	*	*
8	*	*
9	*	*
10	*	*
11	*	*
12	*	*
13	*	*
14	*	*
15	*	*
16	*	*
17	*	*
18	*	*
19	*	*
20	*	*
21	*	*
22	*	*
23	*	*
24	*	*
25	*	*
26	*	*
27	*	*
28	*	*
29	*	*
30	*	*
31	*	*
32	*	*
33	*	*
34	*	*
35	*	*
36	*	*
37	*	*
38	*	*
39	*	*
40	*	*
41	*	*
42	*	*
43	*	*
44	*	*
45	*	*
46	*	*
47	*	*
48	*	*
49	*	*
50	*	*

COORDINATES CANNOT IN THEMSELVES BE USED TO RE-ESTABLISH
CORNERS OR BOUNDARIES SHOWN ON THIS PLAN.

NOTES
1. BEARINGS ARE ASTROLOGICAL, REFERRED TO THE HORIZONAL LINE OF
CARR ROAD SHOWN ON REGISTERED PLAN 751 AS HAVING A BEARING
OF N73°42'30"W.
2. BEARINGS CAN BE CONVERTED TO GRID BY APPLYING AN ANGLE ROTATION TO
MULTIPLY BY THE COMBINED SCALE FACTOR *****.
3. DISTANCES ARE GROUND AND CAN BE CONVERTED TO GRID BY
MULTIPLYING BY THE COMBINED SCALE FACTOR *****.

LEGEND
□ - SURVEY MONUMENT SET
■ - SURVEY MONUMENT FOUND
SB - STANDARD IRON BAR
R - ROUND
IB - IRON BAR
(P) - REGISTERED PLAN 751
(S) - SET
(M) - MEASURED
WT - WITNESS
(SU) - SOURCE UNKNOWN
(857) - FAIRHALL, MOFFATT & WOODLAND LIMITED, O.L.S.
(REF. 1 & 4-751 CLM)
PIN - PROPERTY IDENTIFIER NUMBER

SURVEYOR'S CERTIFICATE
I CERTIFY THAT:
1. THIS SURVEY AND PLAN ARE CORRECT AND IN ACCORDANCE
WITH THE SURVEYS ACT, THE SURVEYS ACT, THE LAND TITLES
ACT AND THE REGULATIONS MADE UNDER THEM.
2. THE SURVEY WAS COMPLETED ON

DATE _____
JOHN H. GUTRI
ONTARIO LAND SURVEYOR
JSS No. Y298200
E349330, NS014377
REFERENCE No.
8(9) - 751 Goulbourn
1, 2, 3, 4, 5, 6, 7, 8, 9, 10, 11, 12, 13, 14, 15, 16, 17, 18, 19, 20, 21, 22, 23, 24, 25, 26, 27, 28, 29, 30, 31, 32, 33, 34, 35, 36, 37, 38, 39, 40, 41, 42, 43, 44, 45, 46, 47, 48, 49, 50
2/28 jplm/dmg (9)

**Fairhall
Moffatt &
Woodland**
O.L.S.
Ontario Land Surveyors
Surveying and Land Information Services
100-400 SHEPPARD AVENUE EAST, SUITE 100, SCARBOROUGH, ONTARIO M1S 1T6
TEL: (416) 291-1111 FAX: (416) 291-1112
WWW.FMW.O.N.S.

SCHEDULE
PART LOT REGD PLAN PIN
1 ALL OF 1 751 ALL OF 04459-0027
2
3

METRIC
DISTANCES AND COORDINATES SHOWN ON THIS PLAN ARE IN METRES
AND CAN BE CONVERTED TO FEET BY DIVIDING BY 0.3048

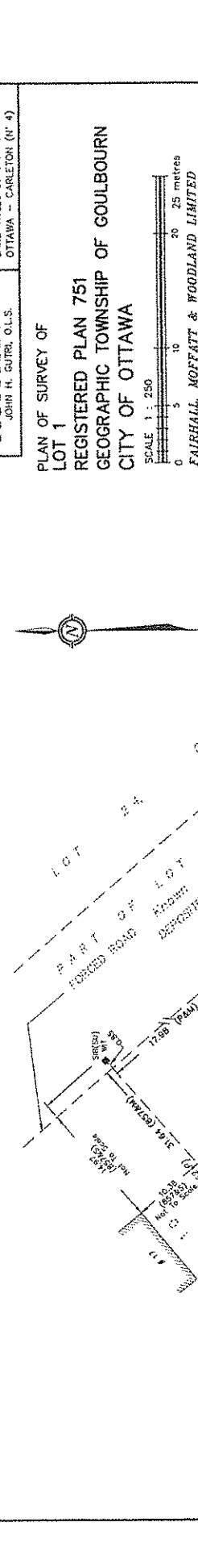

**PLAN OF SURVEY OF
LOT 1
REGISTERED PLAN 751
GEOGRAPHIC TOWNSHIP OF GOULBOURN
CITY OF OTTAWA**

**PLAN PREPARED FOR COMMITTEE
OF ADJUSTMENT PURPOSES**

**Committee
of Adjustment
NOV 28 2013
City of Ottawa**